

TOWN OF BURKE

SERVER DRIVE, ROSTAD DRIVE, AND FELLAND ROAD DANE COUNTY, WI

Mead & Hunt

Mead and Hunt, Inc.
2440 Deming Way
Middleton, WI 53562
phone: 608-273-6380
meadhunt.com

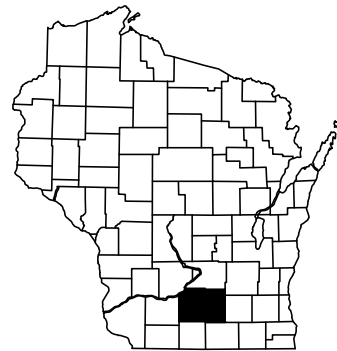

DANE COUNTY

SHEET INDEX

SHEET NUMBER	SHEET TITLE
G-001	COVER SHEET
G-002	GENERAL NOTES AND LEGEND
G-021	OVERALL PROJECT LAYOUT AND SURVEY CONTROL
C-011	TYPICAL SECTIONS
C-041	TRAFFIC CONTROL PLAN
C-101	SERVER DRIVE ROAD PLAN
C-102	ROSTAD DRIVE ROAD PLAN
C-103	ROSTAD DRIVE ROAD PLAN
C-104	ROSTAD DRIVE ROAD PLAN
C-201	FELLAND ROAD PLAN
C-202	FELLAND ROAD PLAN
C-501	SITE DETAILS

© Copyright 2024 Mead & Hunt, Inc.
This document, or any portion thereof, shall not be duplicated, disclosed, or used on any other project or extension of this project except by written agreement with Mead & Hunt, Inc. Mead & Hunt shall not be responsible for any unauthorized use of, or alteration to these documents.

TOWN OF BURKE
SERVER DRIVE, ROSTAD DRIVE
AND FELLAND ROAD
DANE COUNTY, WI

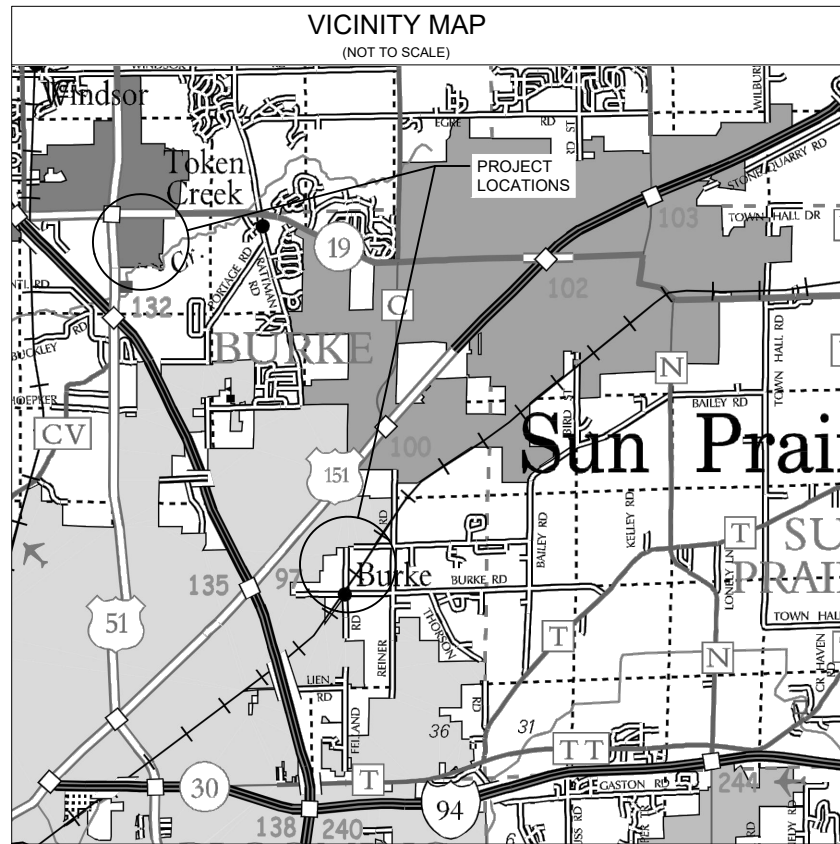

MAP SOURCE: WISCONSIN DEPARTMENT OF TRANSPORTATION

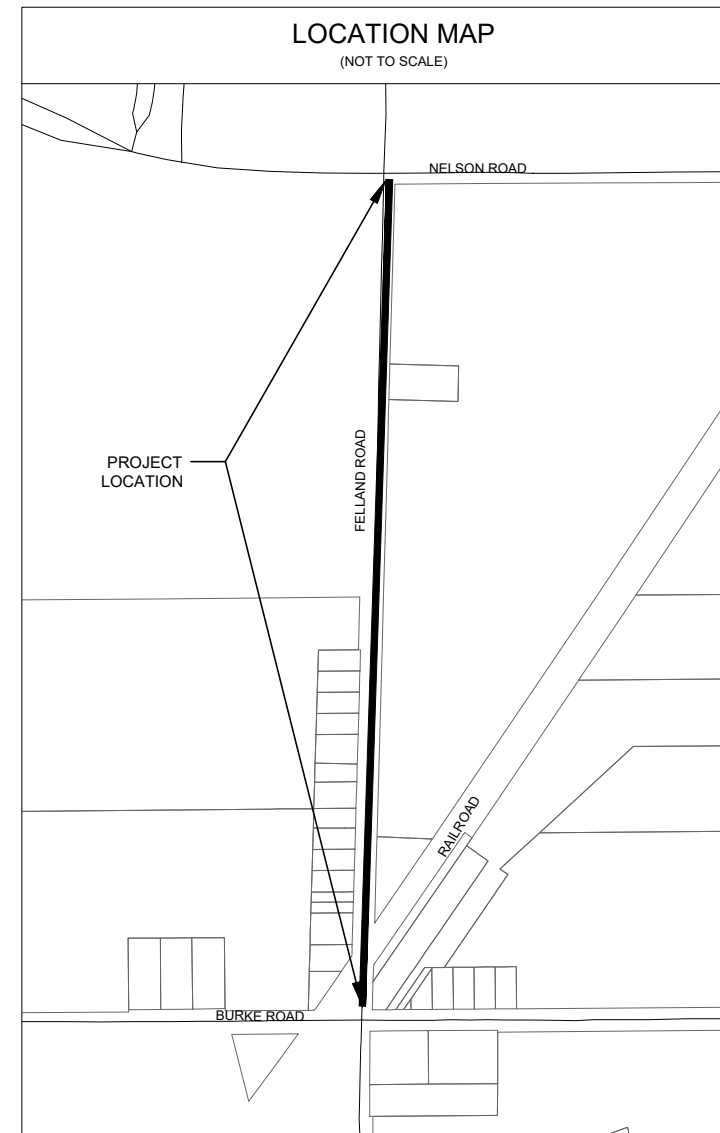
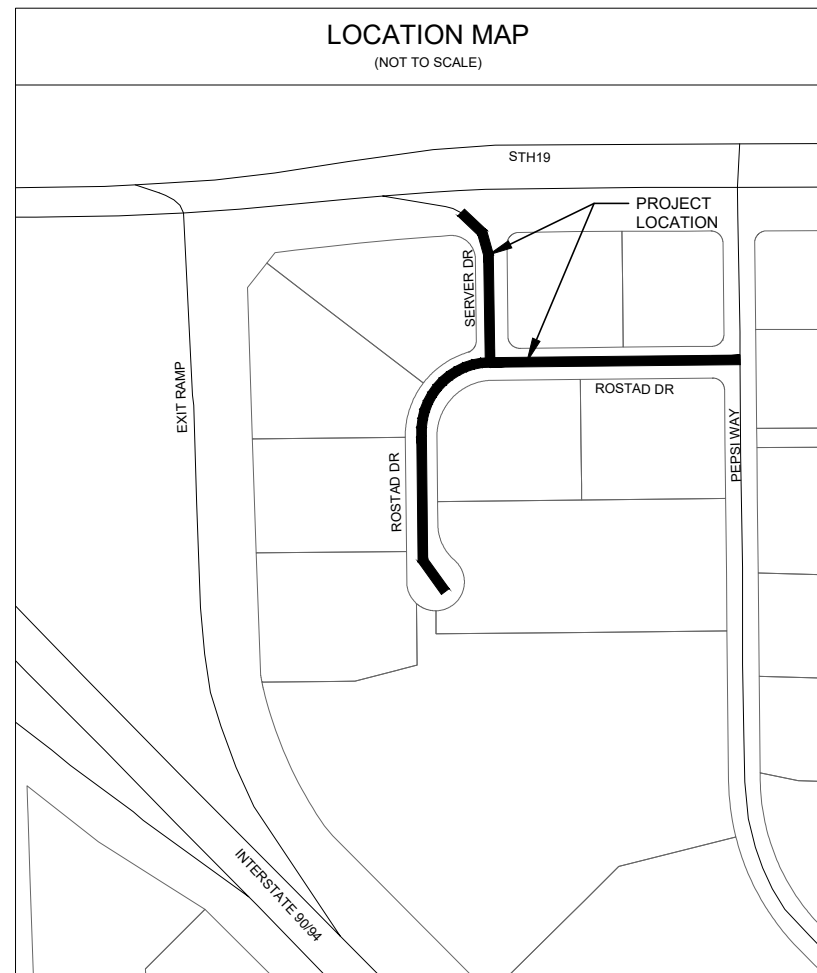

ISSUED 04/30/24 ISSUED FOR BID

NOT FOR CONSTRUCTION

MSH NO: 0207300-232611.01
DATE: April 30, 2024
DESIGNED BY: ACA
DRAWN BY: CAJ
CHECKED BY: SRB
DO NOT SCALE DRAWINGS

SHEET CONTENTS
COVER SHEET

SHEET NO.

G-001

X:\2024\20240430\11\01\TECH\DWG\G-001.DWG
 4/30/2024 10:48:00 AM

GENERAL NOTES

1. ALL PROPERTY LINES SHOWN ARE APPROXIMATE.
2. PUBLIC SUBSURFACE UTILITY LOCATIONS SHOWN HEREON ARE BASED UPON GROUND MARKINGS PLACED BY DIGGERS HOTLINE. DIGGERS HOTLINE DOES NOT GUARANTEE THE PRECISION OF THEIR MARKINGS. IN ACCORDANCE WITH WISCONSIN LAW, SUBSURFACE UTILITIES MUST BE EXPOSED VIA HAND DIGGING BEFORE MACHINE DIGGING IS PERMISSABLE. UTILITY LOCATION MARKINGS ARE VALID FOR ONLY 10 DAYS. CONTRACTOR MUST ORDER NEW UTILITY LOCATE PRIOR TO ANY EXCAVATION.
3. SANITARY SEWER, WATER MAIN AND STORM SEWER LOCATIONS HAVE BEEN DETERMINED BY FIELD MARKINGS, OBSERVABLE SURFACE STRUCTURES AND RESPECTIVE FEATURES. INTERMEDIATE PIPE LOCATIONS ARE APPROXIMATE AS ACCURATE LOCATIONS WERE NOT AVAILABLE AT TIME OF SURVEY.

UTILITY CONTACTS:

VILLAGE OF DEFOREST (SANITARY SEWER, WATERMAIN)	608.576.1504
AT&T MADISON EAST	CAROL ANASON 608.252.2385 ca2624@ATT.COM
ALLIANT ENERGY FIBER	608.223.2014
ALLIANT	BRAND SMITH 608.842.1705 BRANDSMITH@ALLIANTENERGY.COM
MG&E (GAS)	JOHN WICHERN 608.252.1563 JWICHERN@MGE.COM
MG&E (ELECTRIC)	CHRIS ERICKSON 608.252.5670 CERICKSON@MGE.COM
CHARTER	JON MARSCHKE 608.288.6848 608.255.2479 (C) JON.MARSCHKE@CHARTER.COM
TDS METROCOM	262.466.9821
BRIGHTSPEED	833.363.2360
EVERSTREAM	317.538.7933
WISCONSIN DOT (ITS EQUIPMENT)	630.288.9176

EROSION AND SEDIMENT CONTROL NOTES:

1. CONSTRUCTION SITE EROSION AND SEDIMENT CONTROL SHALL COMPLY WITH THE REQUIREMENTS OF DANE COUNTY AND THE WISCONSIN DEPARTMENT OF NATURAL RESOURCES.
2. THE CONTRACTOR SHALL KEEP THE EROSION CONTROL PLAN ON SITE DURING THE CONSTRUCTION FOR REFERENCE.
3. ALL EROSION CONTROL MEASURES SHALL BE ADJUSTED TO MEET STATE AND LOCAL CONDITIONS.
4. INLET PROTECTION SHALL BE INSTALLED PRIOR TO ANY GRADING OR DISTURBANCE OF SURFACE MATERIAL. EROSION MAT AND SEED, FERTILIZER, MULCH SHALL BE INSTALLED IMMEDIATELY AFTER GRADING AND TOPSOIL REPLACEMENT.
5. RESTORE AREAS BEHIND THE CURB WITH SEED AND MULCH. IF DISTURBED AREA IS GREATER THAN 2 FEET WIDE, INSTALL EROSION MAT.
6. THE CONTRACTOR SHALL INSTALL ADDITIONAL EROSION CONTROL MEASURES AS NEEDED.
7. EROSION AND SEDIMENT CONTROL SHALL BE INSPECTED WEEKLY AND WITHIN 24 HOURS OF ANY RAIN EVENT OF 0.5-INCHES OR MORE IN A 24 HOUR PERIOD. THE CONTRACTOR SHALL KEEP A LOG OF ALL INSPECTIONS SHALL BE MAINTAINED THROUGHOUT THE DURATION OF THE PROJECT.
8. CONTRACTOR SHALL BE RESPONSIBLE FOR CLEANUP AND REMOVAL OF ALL SEDIMENT LEAVING THE SITE. EROSION CONTROL MEASURES SHALL BE IN WORKING CONDITION AT THE END OF EACH WORKING DAY.
9. EROSION CONTROL MEASURES SHALL BE MAINTAINED BY THE CONTRACTOR UNTIL THE SITE IS FULLY STABILIZED.
10. THE CONTRACTOR SHALL ALLOW FREE AND UNLIMITED ACCESS TO THE PROJECT SITE AT ANY TIME TO ANY REGULATORY AGENCY EMPLOYEE INSPECTING THE EROSION CONTROL MEASURES.

LEGEND:

	CONTROL POINT
	ELECTRICAL / COMMUNICATIONS PEDESTAL
	ELECTRICAL TRANSFORMER BOX
	ELECTRICAL SERVICE PANEL
	FIRE HYDRANT
	GAS VALVE
	INLET, CURB
	INLET, ROUND
	INLET, SQUARE
	IRON PIN
	LIGHT POLE (SINGLE)
	MAILBOX
	MANHOLE, ELECTRIC
	MANHOLE, FIBER OPTIC
	MANHOLE, SANITARY SEWER
	MANHOLE, STORM SEWER
	MANHOLE, VALVE
	SIGN
	STORM FLARED END SECTION
	TREE, DECIDUOUS
	TREE, CONIFEROUS
	WATER VALVE
	WATER SHUT OFF
	WATER METER
	GAS
	ELECTRIC, OVERHEAD
	ELECTRIC, UNDERGROUND
	EXISTING CONTOUR LINES
	FIBER OPTIC CABLE
	PROPERTY LINE
	SANITARY SEWER
	STORM SEWER / CULVERT
	SWALE
	TELEPHONE
	WATER
	VEGETATION
	INLET PROTECTION
	SILT FENCE
	SAW CUT PAVEMENT
	STRAW WATTLE
	DETAIL REFERENCE
	SHEET REFERENCE
	ASPHALT
	CONCRETE

Mead & Hunt
Mead and Hunt, Inc.
2440 Deming Way
Middleton, WI 53562
phone: 608-273-6380
meadhunt.com

© Copyright 2024 Mead & Hunt, Inc. This document, or any portion thereof, shall not be duplicated, disclosed, or used on any other project or extension of this project except by written agreement with Mead & Hunt, Inc. Mead & Hunt shall not be responsible for any unauthorized use of, or alteration to these documents.

**TOWN OF BURKE
SERVER DRIVE, ROSTAD DRIVE
AND FELLAND ROAD
DANE COUNTY, WI**

ISSUED
04/30/24 ISSUED FOR BID

NOT FOR CONSTRUCTION

MSH NO: 0207300-232611.01
DATE: April 30, 2024
DESIGNED BY: ACA
DRAWN BY: CAJ
CHECKED BY: SRB
DO NOT SCALE DRAWINGS

SHEET CONTENTS
GENERAL NOTES AND
LEGEND

SHEET NO.

G-002

**TOWN OF BURKE
 SERVER DRIVE, ROSTAD DRIVE
 AND FELLAND ROAD**
 DANE COUNTY, WI

ISSUED
 04/30/24 ISSUED FOR BID

NOT FOR CONSTRUCTION

MSH NO.: 0207300-232611.01
 DATE: April 30, 2024
 DESIGNED BY: ACA
 DRAWN BY: CAJ
 CHECKED BY: SRB
 DO NOT SCALE DRAWINGS

SHEET CONTENTS
 OVERALL PROJECT
 LAYOUT AND SURVEY
 CONTROL

SHEET NO.

SITE SURVEY PLAN NOTES:

- PRIVATE SUBSURFACE UTILITY LOCATIONS SHOWN HEREON ARE BASED UPON GROUND MARKINGS PLACED BY CLIENT REPRESENTATIVE. MARKINGS MAY NOT BE BY BENEFIT OF SUBSURFACE DETECTING INSTRUMENTS AS SOME WERE MARKED PER PERSONNEL BEST RECOLLECTION.
- PUBLIC SUBSURFACE UTILITY LOCATIONS SHOWN HEREON ARE BASED UPON GROUND MARKINGS PLACED BY DIGGERS HOTLINE. DIGGERS HOTLINE DOES NOT GUARANTEE THE PRECISION OF THEIR MARKINGS. IN ACCORDANCE WITH WISCONSIN LAW, SUBSURFACE UTILITIES MUST BE EXPOSED VIA HAND DIGGING BEFORE MACHINE DIGGING IS PERMISSABLE. UTILITY LOCATION MARKINGS ARE VALID FOR ONLY 10 DAYS. CONTRACTOR MUST ORDER NEW UTILITY LOCATE PRIOR TO ANY EXCAVATION.
- SANITARY SEWER AND STORM SEWER LOCATIONS HAVE BEEN DETERMINED BY OBSERVABLE SURFACE STRUCTURES AND RESPECTIVE FEATURES. INTERMEDIATE PIPE LOCATIONS ARE APPROXIMATE AS ACCURATE LOCATIONS WERE NOT AVAILABLE AT TIME OF SURVEY.
- CONTROL POINTS AND BENCHMARKS SHOWN HEREON ARE FOR REFERENCE PURPOSES ONLY. PRIOR TO STAKING, THE CONTROL MUST BE INDEPENDENTLY VERIFIED AS UNDISTURBED. NO WARRANTY IS MADE WITH RESPECT TO THE ACCURACY OF CONTROL SHOWN HEREON AS THEY ARE SUBJECT TO POTENTIAL DISTURBANCE.

SURVEY DATA:

SURVEY DATE(S) DECEMBER 2023
 COORDINATE SYSTEM WISCONSIN DANE COUNTY
 VERTICAL DATUM USGS NAVD 88
 SURVEY UNITS US SURVEY FOOT

SURVEY CONTROL DATA

POINT #	RAW DESCRIPTION	ELEVATION	NORTHING	EASTING
CP105	CPS PK	877.92	526422.748	833442.175
CP107	CPS PK	882.52	526401.919	833999.023

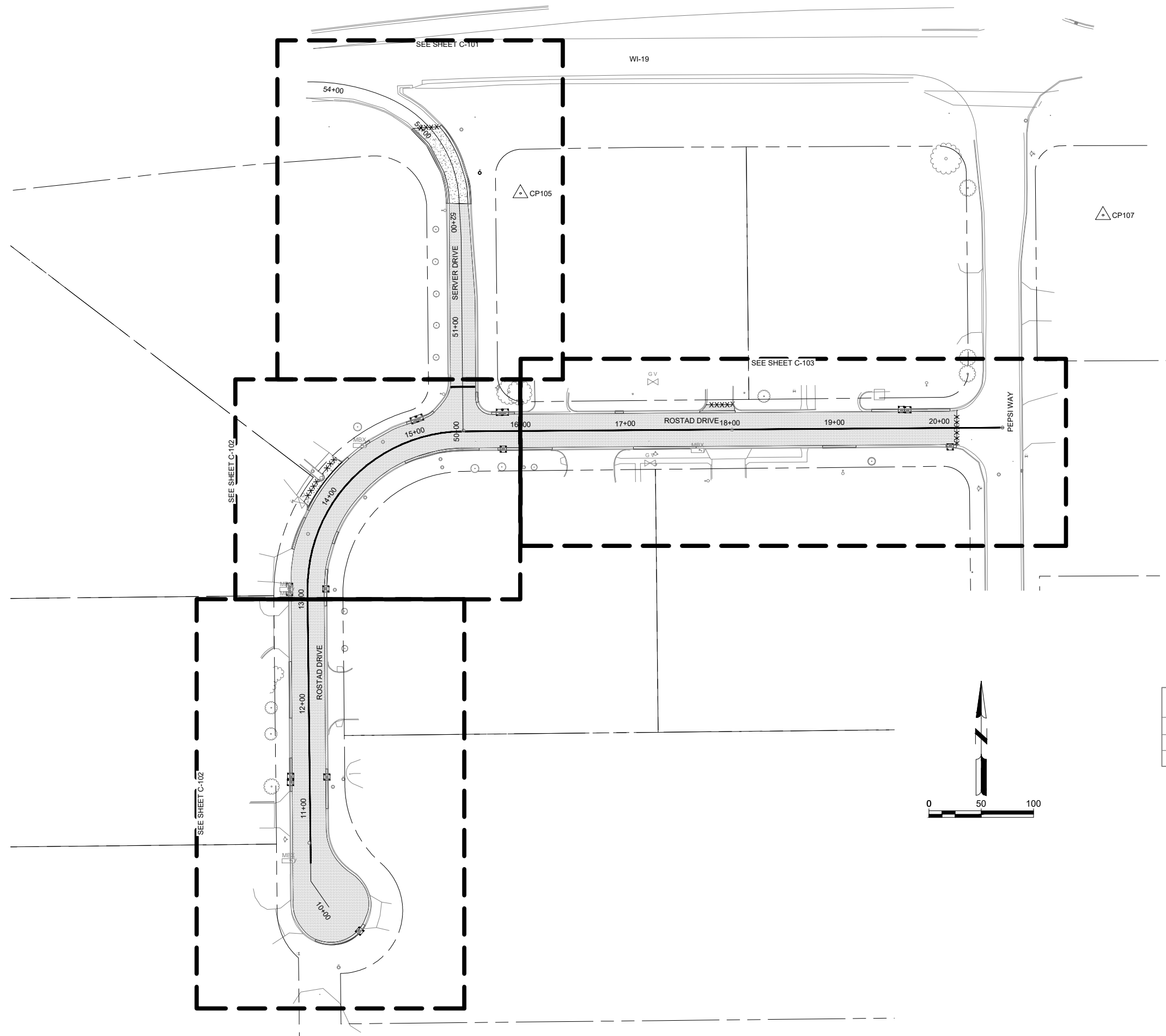
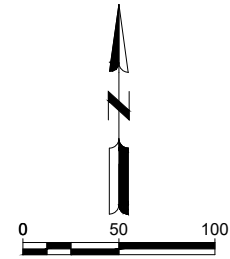

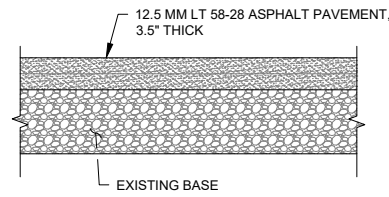

SECTION

3 ASPHALT DRIVEWAY SECTION
NOT TO SCALE

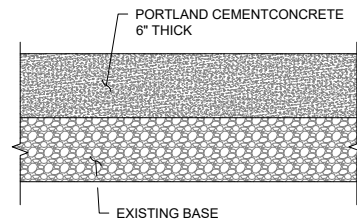

SECTION

4 CONCRETE DRIVEWAY SECTION
NOT TO SCALE

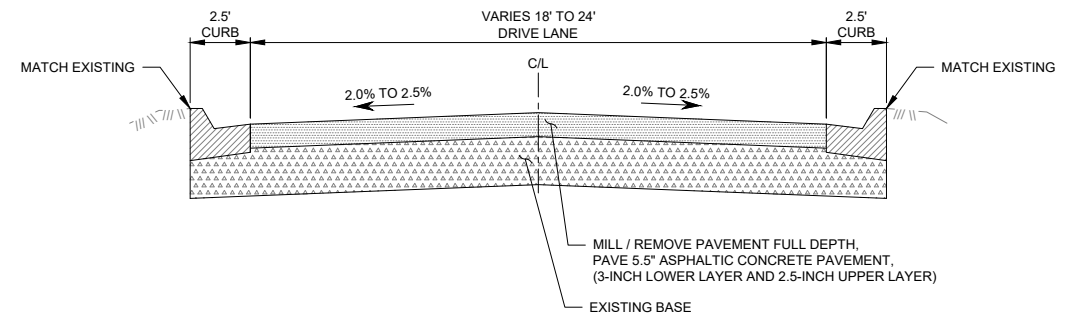

1 SERVER DRIVE ASPHALT ROAD SECTION
NOT TO SCALE

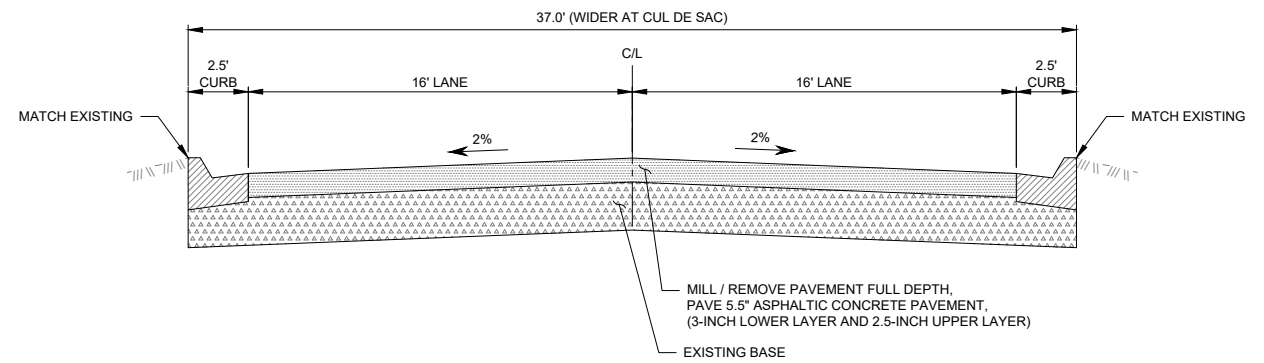

2 ROSTAD DRIVE ASPHALT ROAD SECTION
NOT TO SCALE

**TOWN OF BURKE
SERVER DRIVE, ROSTAD DRIVE
AND FELLAND ROAD**
DANE COUNTY, WI

ISSUED 04/30/24 ISSUED FOR BID

NOT FOR CONSTRUCTION

MSH NO: 0207300-232611.01
DATE: April 30, 2024
DESIGNED BY: ACA
DRAWN BY: CAJ
CHECKED BY: SRB
DO NOT SCALE DRAWINGS

SHEET CONTENTS
TRAFFIC CONTROL PLAN

SHEET NO.

C-041

TRAFFIC CONTROL PLAN NOTES:

1. TRAFFIC CONTROL FOR SERVER DRIVE CLOSURE AS SHOWN.
2. TRAFFIC CONTROL FOR ROSTAD DRIVER PER CONTRACTOR SUBMITTED PLAN IN ACCORDANCE WITH MUTCD.



**TOWN OF BURKE
SERVER DRIVE, ROSTAD DRIVE
AND FELLAND ROAD
DANE COUNTY, WI**

ISSUED
04/30/24 ISSUED FOR BID

NOT FOR CONSTRUCTION

MSH NO: 0207300-232611.01
DATE: April 30, 2024
DESIGNED BY: ACA
DRAWN BY: CAJ
CHECKED BY: SRB
DO NOT SCALE DRAWINGS

SHEET CONTENTS
SERVER DRIVE ROAD
PLAN

SHEET NO.

C-101

KEYED NOTES: (XXX)

- 1.101 MILL AND OVERLAY ASPHALT
- 1.102 REMOVE AND REPLACE CONCRETE DRIVE, SAW CUT
- 1.103 REMOVE AND REPLACE ASPHALT DRIVE, SAW CUT
- 1.104 INLET PROTECTION
- 1.105 REMOVE AND REPLACE 30" CURB AND GUTTER, SAW CUT
- 1.106 REMOVE AND REPLACE 36" CURB AND GUTTER, SAW CUT
- 1.107 REGROUT PIPE CONNECTIONS IN STRUCTURE
- 1.108 INSTALL 30" DRIVEWAY CURB AND GUTTER
- 1.111 DOUBLE 6" SOLID YELLOW CENTERLINE
- 1.112 18" SOLID WHITE STOP LINE
- 1.113 REMOVE CONCRETE, REPLACE WITH ASPHALT

SANITARY STRUCTURES TABLE

STRUCTURE	RIM	SIZE	MATERIAL	DIRECTION	INVERT
MHS-18	879.82	12"	PVC	W	865.78
		12"	PVC	E	865.78
		8"	PVC	S	866.02

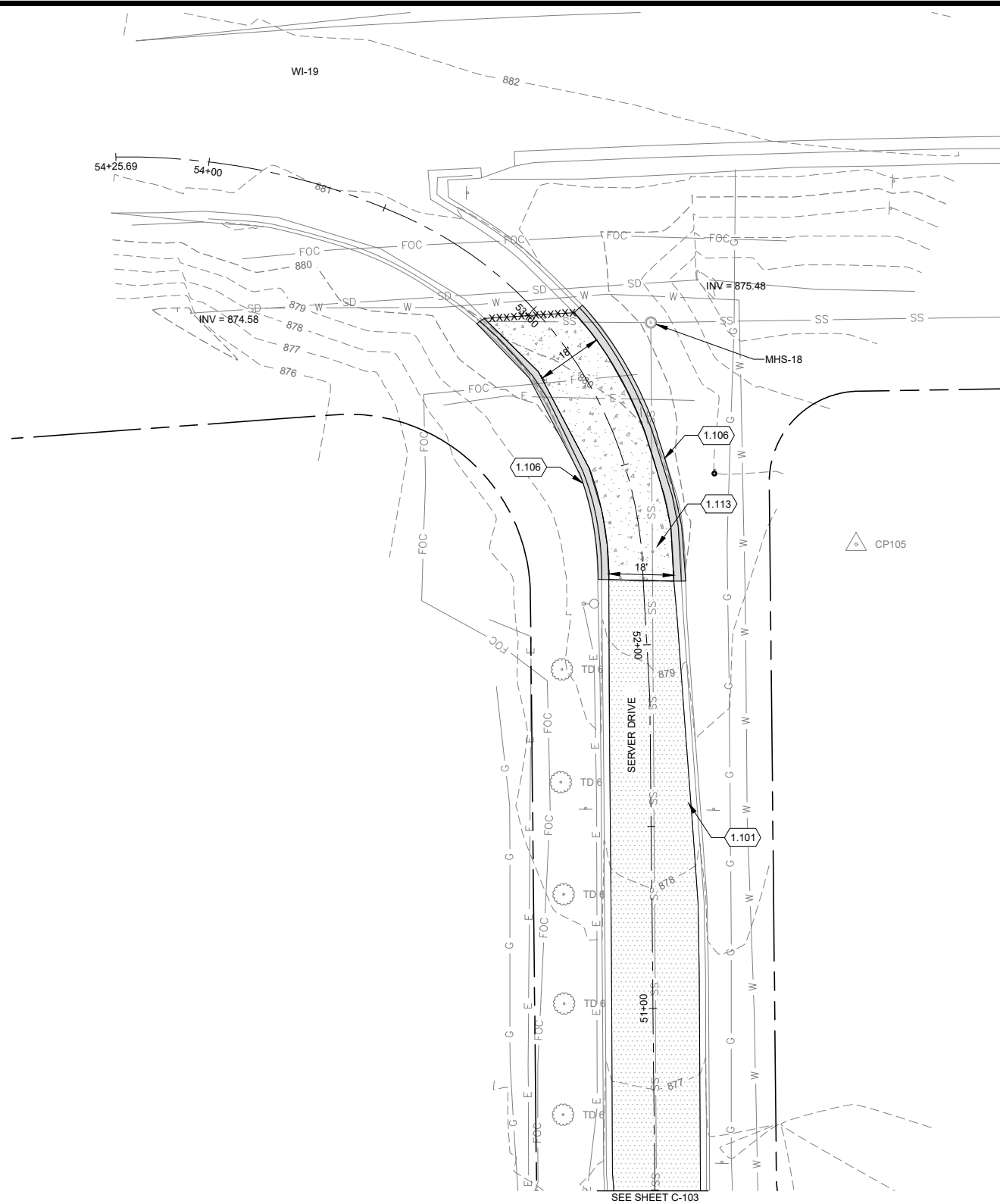
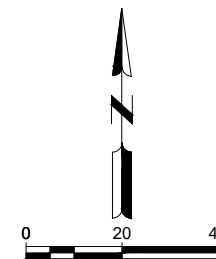

TOWN OF BURKE
SERVER DRIVE, ROSTAD DRIVE
AND FELLAND ROAD
 DANE COUNTY, WI

KEYED NOTES: (XXX)

- 1.101 MILL AND OVERLAY ASPHALT
- 1.102 REMOVE AND REPLACE CONCRETE DRIVE, SAW CUT
- 1.103 REMOVE AND REPLACE ASPHALT DRIVE, SAW CUT
- 1.104 INLET PROTECTION
- 1.105 REMOVE AND REPLACE 30" CURB AND GUTTER, SAW CUT
- 1.106 REMOVE AND REPLACE 36" CURB AND GUTTER, SAW CUT
- 1.107 REGROUT PIPE CONNECTIONS IN STRUCTURE
- 1.108 INSTALL 30" DRIVEWAY CURB AND GUTTER
- 1.111 DOUBLE 6" SOLID YELLOW CENTERLINE
- 1.112 18" SOLID WHITE STOP LINE
- 1.114 ADJUST MANHOLE RIM

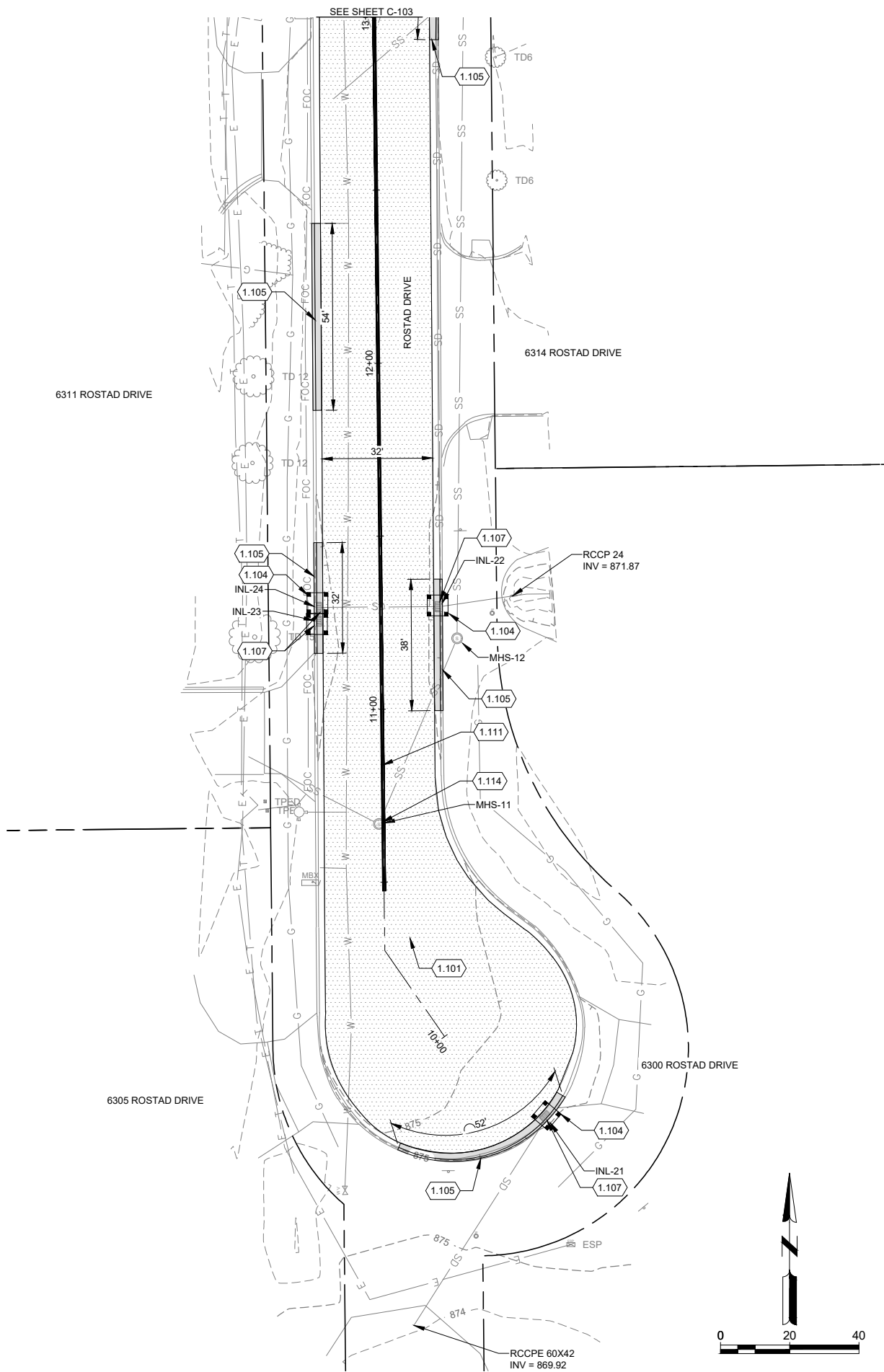

STORM STRUCTURES TABLE					
STRUCTURE	RIM	SIZE	MATERIAL	DIRECTION	INVERT
INL-21	874.29	12"	RCP	SW	871.81
		66x42	RCCPE	S	869.93
INL-22	874.73	42"	RCP	N	870.48
		24"	RCP	E	870.93
		24"	RCP	W	870.73
INL-23	874.65	12"	RCP	N	871.95
		12"	RCP	W	872.34
INL-24	874.67	24"	RCP	E	871.72
		12"	RCP	S	871.95

SANITARY STRUCTURES TABLE					
STRUCTURE	RIM	SIZE	MATERIAL	DIRECTION	INVERT
MHS-11	875.52	8"	PVC	NE	869.50
MHS-12	875.39	8"	PVC	NW	869.51
		8"	PVC	N	869.43
		8"	PVC	SW	869.43

ISSUED 04/30/24 ISSUED FOR BID

NOT FOR CONSTRUCTION

MSH NO: 0207300-232611.01
 DATE: April 30, 2024
 DESIGNED BY: ACA
 DRAWN BY: CAJ
 CHECKED BY: SRB
 DO NOT SCALE DRAWINGS

SHEET CONTENTS
 ROSTAD DRIVE ROAD
 PLAN

SHEET NO.

**TOWN OF BURKE
SERVER DRIVE, ROSTAD DRIVE
AND FELLAND ROAD**
DANE COUNTY, WI

ISSUED 04/30/24 ISSUED FOR BID

NOT FOR CONSTRUCTION

MSH NO: 0207300-232611.01
DATE: April 30, 2024
DESIGNED BY: ACA
DRAWN BY: CAJ
CHECKED BY: SRB
DO NOT SCALE DRAWINGS

SHEET CONTENTS
ROSTAD DRIVE ROAD
PLAN

SHEET NO.

KEYED NOTES: (XXX)

- 1.101 MILL AND OVERLAY ASPHALT
- 1.102 REMOVE AND REPLACE CONCRETE DRIVE, SAW CUT
- 1.103 REMOVE AND REPLACE ASPHALT DRIVE, SAW CUT
- 1.104 INLET PROTECTION
- 1.105 REMOVE AND REPLACE 30" CURB AND GUTTER, SAW CUT
- 1.106 REMOVE AND REPLACE 36" CURB AND GUTTER, SAW CUT
- 1.107 REGROUT PIPE CONNECTIONS IN STRUCTURE
- 1.108 INSTALL 30" DRIVEWAY CURB AND GUTTER
- 1.111 DOUBLE 6" SOLID YELLOW CENTERLINE
- 1.112 18" SOLID WHITE STOP LINE
- 1.114 ADJUST MANHOLE RIM
- 1.115 YELLOW CURB MARKING IN FRONT OF HYDRANT

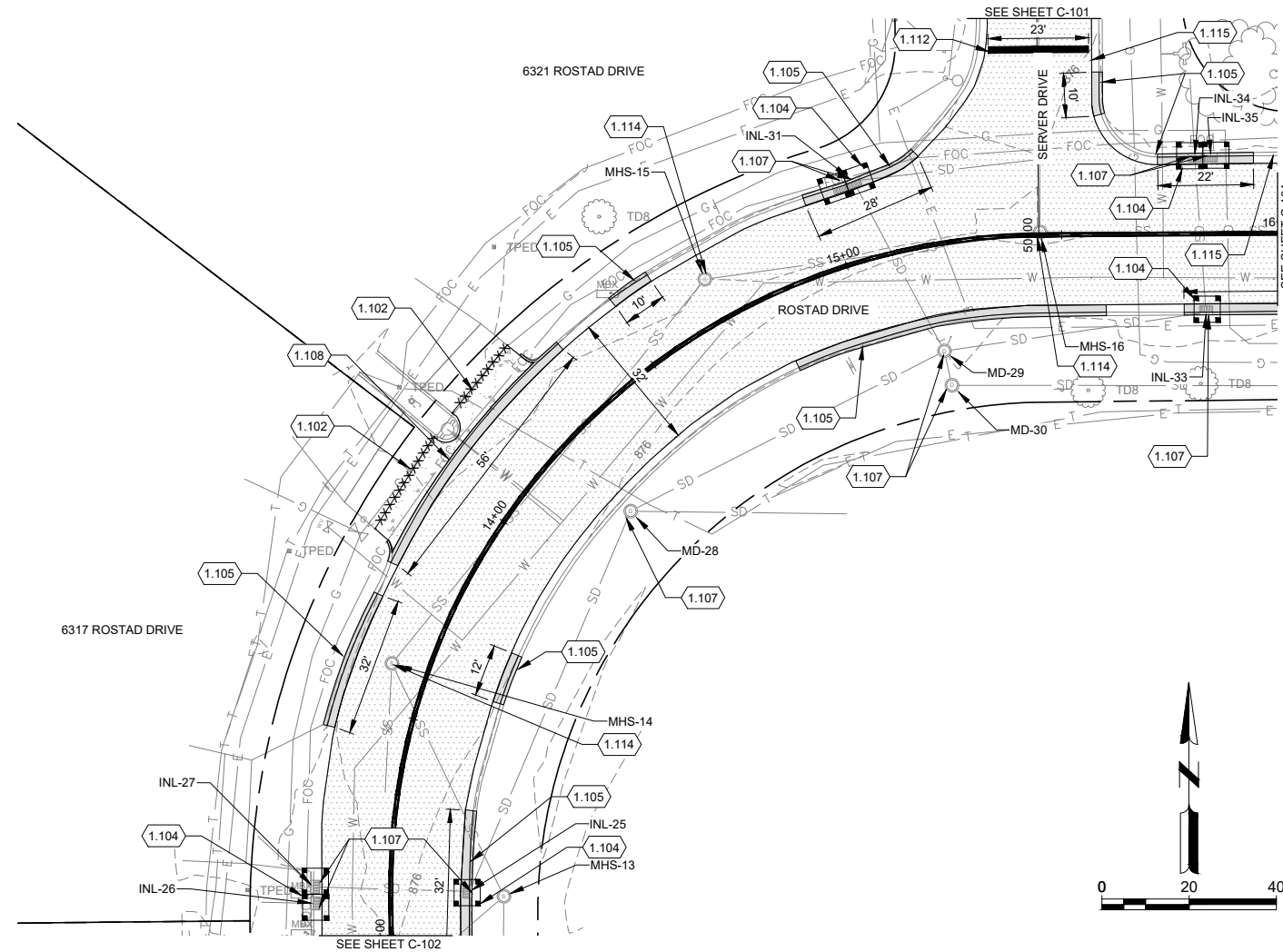

STORM STRUCTURES TABLE					
STRUCTURE	RIM	SIZE	MATERIAL	DIRECTION	INVERT
INL-25	875.65	42"	RCP	S	872.03
		36"	RCP	NE	871.00
		24"	RCP	W	870.67
INL-26	875.52	12"	RCP	N	872.52
		12"	RCP	W	873.19
INL-27	875.51	24"	RCP	E	872.41
		10"	PVC	NW	872.46
		12"	RCP	S	872.52
MD-28	876.40	36"	RCP	S	870.21
		36"	RCP	E	871.72
		12"	RCP	NE	871.14
MD-29	876.01	36"	RCP	W	871.22
		24"	RCP	N	871.24
		24"	RCP	E	871.44
MD-30	876.07	15"	RCP	S	871.59
		15"	RCP	N	871.70
		15"	RCP	E	871.76
INL-31	875.51	24"	RCP	SE	872.17
		15"	RCP	W	872.22
		18"	RCP	E	872.46
INL-32	875.51	15"	RCP	E	872.29
		24"	RCP	W	872.36
INL-33	875.22	24"	RCP	N	872.36
		24"	RCP	S	872.60
INL-34	875.27	24"	RCP	N	872.65
		15"	RCP	E	872.72
INL-35	875.23	15"	RCP	W	872.75

SANITARY STRUCTURES TABLE					
STRUCTURE	RIM	SIZE	MATERIAL	DIRECTION	INVERT
MHS-13	876.59	8"	PVC	NW	868.67
		8"	PVC	S	868.67
		8"	PVC	SW	868.78
MHS-14	876.07	8"	PVC	NE	868.35
		8"	PVC	S	868.44
		8"	PVC	SW	868.44
MHS-15	876.00	8"	PVC	E	867.72
		8"	PVC	SW	867.75
		8"	PVC	N	867.13
MHS-16	875.99	8"	PVC	W	867.18
		8"	PVC	E	867.21

© Copyright 2024 Mead & Hunt, Inc.
This document, or any portion thereof, shall not be duplicated, disclosed, or used on any other project or extension of this project except by written agreement with Mead & Hunt, Inc. Mead & Hunt shall not be responsible for any unauthorized use of, or alteration to these documents.

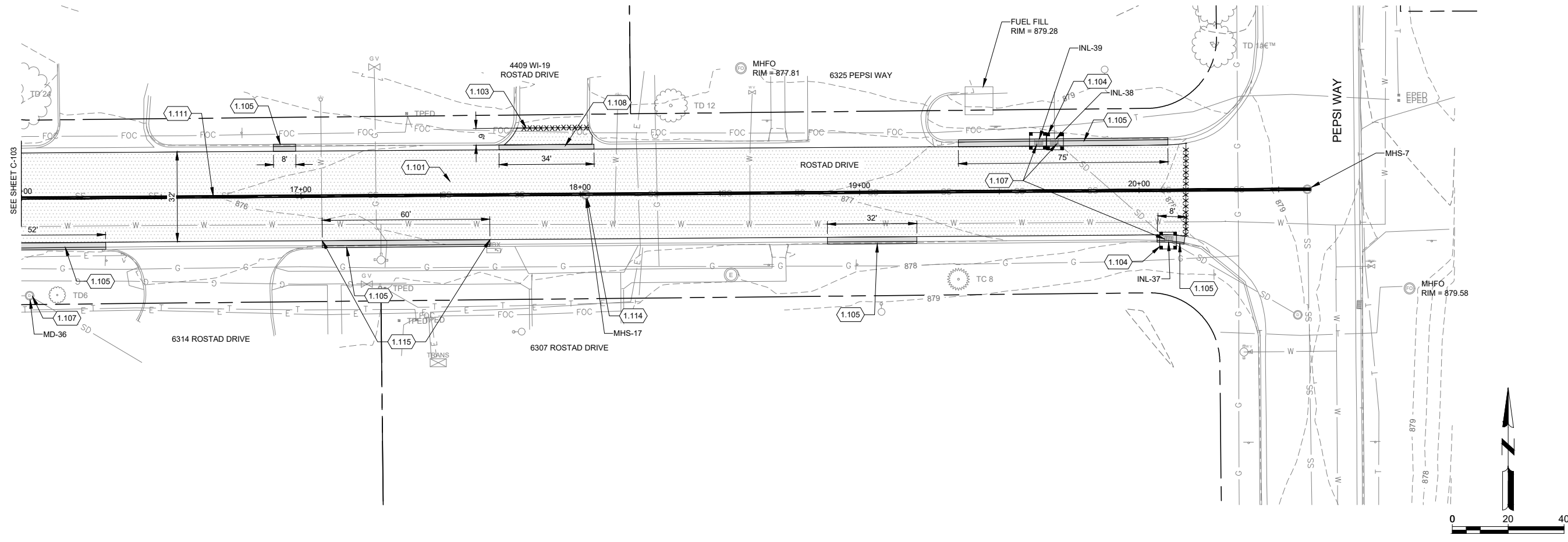

KEYED NOTES: (X-XXX)

- 1.101 MILL AND OVERLAY ASPHALT
- 1.102 REMOVE AND REPLACE CONCRETE DRIVE, SAW CUT
- 1.103 REMOVE AND REPLACE ASPHALT DRIVE, SAW CUT
- 1.104 INLET PROTECTION
- 1.105 REMOVE AND REPLACE 30" CURB AND GUTTER, SAW CUT
- 1.106 REMOVE AND REPLACE 36" CURB AND GUTTER, SAW CUT
- 1.107 REGROUT PIPE CONNECTIONS IN STRUCTURE
- 1.108 INSTALL 30" DRIVEWAY CURB AND GUTTER
- 1.111 DOUBLE 6" SOLID YELLOW CENTERLINE
- 1.112 18" SOLID WHITE STOP LINE
- 1.114 ADJUST MANHOLE RIM
- 1.115 YELLOW CURB MARKING IN FRONT OF HYDRANT

STORM STRUCTURES TABLE

STRUCTURE	RIM	SIZE	MATERIAL	DIRECTION	INVERT
MD-36	876.12	15"	RCP	W	872.35
		15"	RCP	SE	872.37
		18"	RCP	SE	873.92
INL-37	877.52	18"	RCP	NW	873.92
		18"	RCP	SE	874.06
INL-38	877.07	18"	RCP	N	874.19
		18"	RCP	W	874.17
		18"	RCP	E	874.08

SANITARY STRUCTURES TABLE

STRUCTURE	RIM	SIZE	MATERIAL	DIRECTION	INVERT
MHS-7	879.28	8"	PVC	W	869.46
		8"	PVC	S	869.40
		8"	PVC	W	868.26
MHS-17	876.68	8"	PVC	E	868.26

TOWN OF BURKE
SERVER DRIVE, ROSTAD DRIVE
AND FELLAND ROAD
 DANE COUNTY, WI

ISSUED
04/30/24 ISSUED FOR BID

NOT FOR CONSTRUCTION

MSH NO: 0207300-232611.01
DATE: April 30, 2024
DESIGNED BY: ACA
DRAWN BY: CAJ
CHECKED BY: SRB
DO NOT SCALE DRAWINGS

SHEET CONTENTS
ROSTAD DRIVE ROAD PLAN

SHEET NO.

**TOWN OF BURKE
SERVER DRIVE, ROSTAD DRIVE
AND FELLAND ROAD**
DANE COUNTY, WI

ISSUED
04/30/24 ISSUED FOR BID

NOT FOR CONSTRUCTION

MSH NO.: 0207300-232611.01
DATE: April 30, 2024
DESIGNED BY: ACA
DRAWN BY: CAJ
CHECKED BY: SRB
DO NOT SCALE DRAWINGS

SHEET CONTENTS
FELLAND ROAD PLAN

SHEET NO.

C-201

KEYED NOTES: (XXX)

- 1.201 MILL 1.5" ASPHALT AND PAVE 1.5" ASPHALT, 9.5 MM LT MIX, INSTALL 2' GRAVEL SHOULDER
- 1.202 RESTRIPE RAILROAD MARKINGS
- 1.203 DOUBLE SAW CUT, 6"-12" APART, REMOVE PAVEMENT BETWEEN SAW CUTS REPLACE WITH PAVEMENT IN KIND
- 1.204 PAVE 1.5" ASPHALT, 9.5 MM LT MIX
- 1.205 RESTRIPE PAVED AREA WITH DOUBLE YELLOW CENTER LINE AND WHITE EDGE LINES
- 1.206 RESTRIPE 18" STOP LINE
- 1.207 INSTALL 2' GRAVEL SHOULDER
- 1.208 TRAFFIC CONTROL PLAN SHALL BE SUBMITTED FOR APPROVAL. FELLAND ROAD CAN BE CLOSED FOR INTERVALS OF LESS THAN 10 HOURS PROVIDED ACCESS IS GRANTED TO LANDOWNERS AS NEEDED. CONTRACTOR SHALL COORDINATE CLOSURES ACCORDINGLY WITH TOWN AND LANDOWNERS.



SEE C-202 TOP

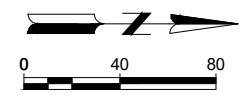

TOWN OF BURKE SERVER DRIVE, ROSTAD DRIVE AND FELLAND ROAD

DANE COUNTY, WI

ISSUED 04/30/24 ISSUED FOR BID

NOT FOR CONSTRUCTION

MSH NO: 0207300-232611.01
DATE: April 30, 2024
DESIGNED BY: ACA
DRAWN BY: CAJ
CHECKED BY: SRB
DO NOT SCALE DRAWINGS

SHEET CONTENTS
FELLAND ROAD PLAN

SHEET NO.

C-202

KEYED NOTES: XXX

- 1.201 MILL 1.5" ASPHALT AND PAVE 1.5" ASPHALT, 9.5 MM LT MIX, INSTALL 2' GRAVEL SHOULDER
- 1.202 RESTRIPE RAILROAD MARKINGS
- 1.203 DOUBLE SAW CUT, 6"-12" APART, REMOVE PAVEMENT BETWEEN SAW CUTS REPLACE WITH PAVEMENT IN KIND
- 1.204 PAVE 1.5" ASPHALT, 9.5 MM LT MIX
- 1.205 RESTRIPE PAVED AREA WITH DOUBLE YELLOW CENTER LINE AND WHITE EDGE LINES
- 1.206 RESTRIPE 18" STOP LINE
- 1.207 INSTALL 2' GRAVEL SHOULDER
- 1.208 TRAFFIC CONTROL PLAN SHALL BE SUBMITTED FOR APPROVAL. FELLAND ROAD CAN BE CLOSED FOR INTERVALS OF LESS THAN 10 HOURS PROVIDED ACCESS IS GRANTED TO LANDOWNERS AS NEEDED. CONTRACTOR SHALL COORDINATE CLOSURES ACCORDINGLY WITH TOWN AND LANDOWNERS.



SEE SHEET C-201 BOTTOM

SEE BELOW



SEE ABOVE



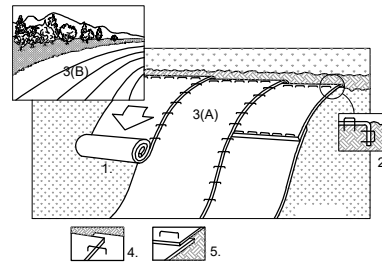

SLOPE INSTALLATION



CHANNEL INSTALLATION

1. PREPARE SOIL BEFORE INSTALLING BLANKETS, INCLUDING SEED.
2. BEGIN AT THE TOP OF THE SLOPE OR CHANNEL BY ANCHORING THE BLANKET IN 6" DEEP X 6" WIDE TRENCH. BACKFILL AND COMPACT THE TRENCH AFTER STAPLING.
3. ROLL THE BLANKETS (3A.) DOWN OR (3B.) HORIZONTALLY ACROSS THE SLOPE.
4. THE EDGES OF PARALLEL BLANKETS SHALL BE STAPLED WITH 4" OVERLAP. USE ONLY BIODEGRADABLE STAPLES.
5. WHEN BLANKETS MUST BE SPLICED DOWN THE SLOPE OR CHANNEL, PLACE BLANKETS END OVER END (SHINGLE STYLE) WITH 6" OVERLAP. STAPLE APPROXIMATELY 12" APART.
6. ALL BLANKETS MUST BE SECURELY FASTENED TO THE SLOPE OR CHANNEL BY PLACING STAPLES/STAKES IN APPROPRIATE LOCATIONS AS RECOMMENDED BY THE MANUFACTURER.
7. USE EROSION CONTROL REVEGETATIVE MAT (ECRM) CLASS-1, TYPE-B.

3 EROSION MAT INSTALLATION DETAIL
NOT TO SCALE

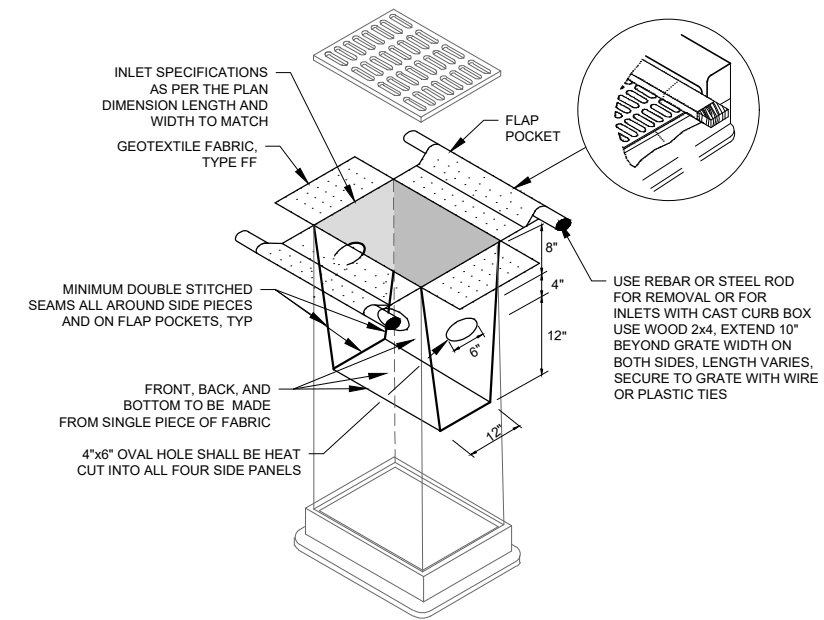

1 INLET PROTECTION DETAIL, TYPE D
NOT TO SCALE

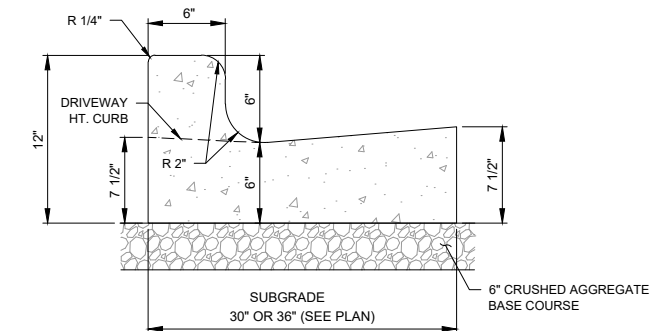

- NOTES:
1. PROVIDE CONTRACTION JOINTS AT MAXIMUM 15-FOOT SPACING.
 2. PROVIDE EXPANSION JOINTS AT ALL POINTS OF CURVATURE, AND ON EACH SIDE OF INLETS, 3-FEET FROM INLET BUT NO CLOSER THAN 3-FEET FROM AN ADJACENT EXPANSION JOINT. MAXIMUM 125-FOOT SPACING.

2 30" AND 36" CURB AND GUTTER DETAIL
NOT TO SCALE

TOWN OF BURKE
SERVER DRIVE, ROSTAD DRIVE
AND FELLAND ROAD
DANE COUNTY, WI

ISSUED 04/30/24 ISSUED FOR BID

NOT FOR CONSTRUCTION

MSH NO: 0207300-232611.01
DATE: April 30, 2024
DESIGNED BY: ACA
DRAWN BY: CAJ
CHECKED BY: SRB
DO NOT SCALE DRAWINGS

SHEET CONTENTS
SITE DETAILS

SHEET NO.